

BenQ

InstaShow™

Plug & Play Wireless Presentation Solution



Unparalleled Meeting Efficiency with the Touch of a Button

BenQ

BenQ Europe B.V.
Meerenakkerweg 1-17,
5652 AR Eindhoven,
The Netherlands
Tel : +31-88-888-9200
Fax : +31-88-888-9299

BenQ Austria GmbH
Central & Eastern Europe
Altmannsdorfer Strasse 89 Top 6
1120 Vienna
Austria
Tel : +43-1-38-00-300
Fax : +43-1-38-00-399

BenQ Deutschland GmbH
Essener Straße 5
46047 Oberhausen
Germany
Tel : +49-208-409-42-0
Fax : +49-208-409-42-99

BenQ Deutschland GmbH
Niederlassung Österreich
Wehlstraße 27b / Stg. 2 / Top 5
1200 Vienna
Austria
Tel : +43-190-7276-0

BenQ Deutschland GmbH
Zweigniederlassung Baden
Täferstrasse 32
5045 Baden-Dättwil
Switzerland
Tel : +41-44-74399-99
Fax : +41-44-74399-00

BenQ Benelux B.V.
Meerenakkerweg 1-17,
5652 AR Eindhoven,
The Netherlands
Tel : +31-88-888-9200
Fax : +31-88-888-9299

BenQ Nordic AB
Mättbandsvägen 12
Box 7101
S-187 12 Täby
Sweden
Tel: +46-8-588-98-800
Fax: + 46-8-588-98-899

BenQ UK Ltd.
3 Staplehurst Office Centre,
Weston-on-the-Green,
Bicester Oxfordshire OX25
3QU
United Kingdom
Tel: +44-870-850-4417
Fax: +44-870-850-4418

BenQ Italy s.r.l.
Via La Spezia, 1
20142 Milano
Italy
Tel : +39-02-89879-790

BenQ France SAS
La Boursidière
RN186 92357
Le Plessis-Robinson
France
Tel: +33-0-1-7037-1717
Fax : +33-0-1-7037-1799

BenQ Technology Iberica S.L.U.
Calle Constitucion, 3 (2-1)
08960 Sant Just Desvern
Spain
Tel : +34-93-556-0800
Fax : +34-93-556-0899

BenQ Europe B.V.
Representative Office in Russia
Park Place Moscow, 113/1
Leninsky, Prospekt B-101,
117198 Moscow
Russia
Tel : +7-095-937-8532
Fax : +7-095-626-5196

business-display.benq.eu

© Copyright 2019 BenQ Corporation. All rights reserved. Corporate names and trademarks are the property of their respective companies. Specifications subject to change without notice. Please contact your local BenQ office for the full BenQ product range.

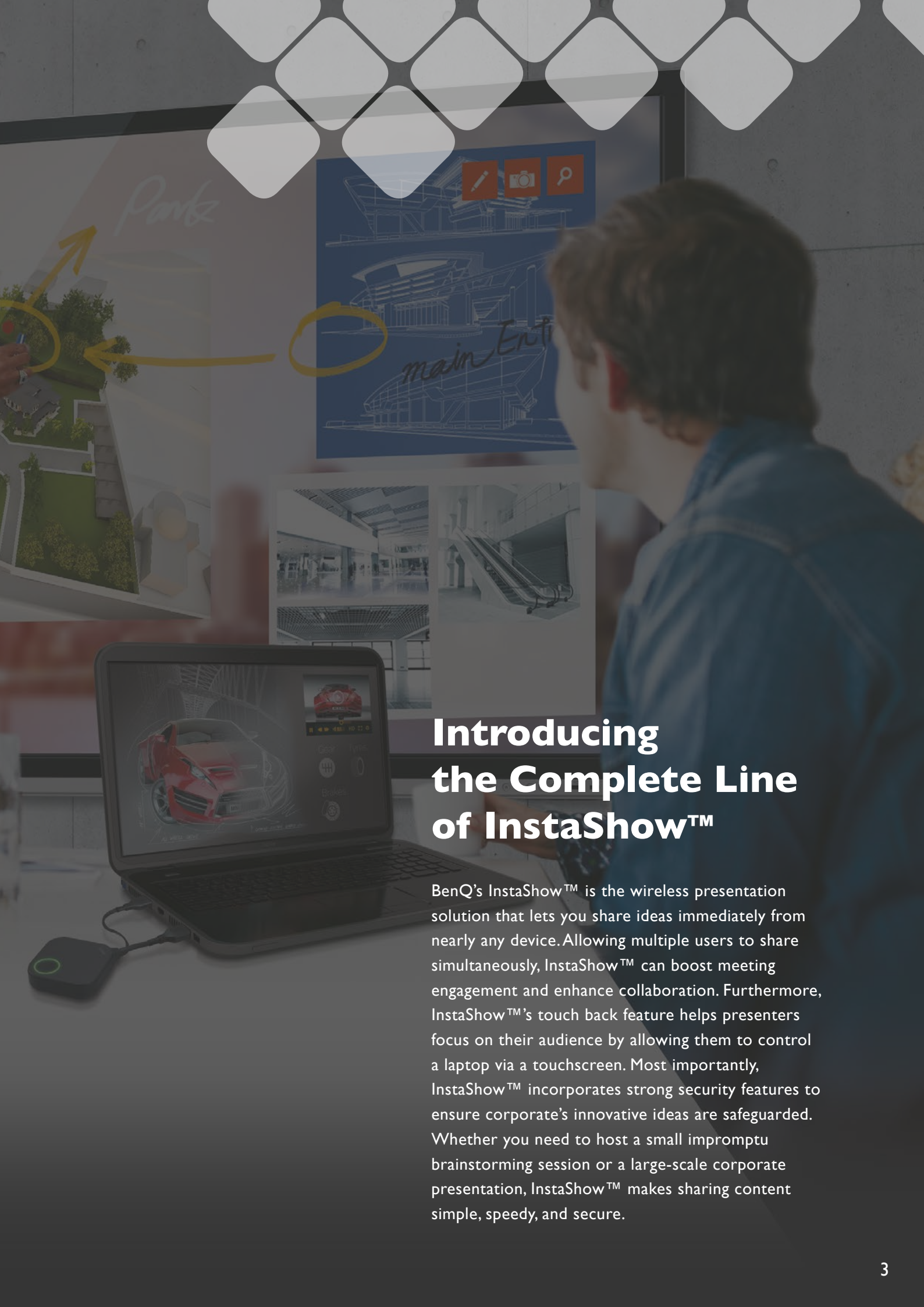

Introducing the Complete Line of InstaShow™

BenQ's InstaShow™ is the wireless presentation solution that lets you share ideas immediately from nearly any device. Allowing multiple users to share simultaneously, InstaShow™ can boost meeting engagement and enhance collaboration. Furthermore, InstaShow™'s touch back feature helps presenters focus on their audience by allowing them to control a laptop via a touchscreen. Most importantly, InstaShow™ incorporates strong security features to ensure corporate's innovative ideas are safeguarded. Whether you need to host a small impromptu brainstorming session or a large-scale corporate presentation, InstaShow™ makes sharing content simple, speedy, and secure.

InstaShow™: Relentless Innovation Flawless Presentation

InstaShow™ Plug & Play Instant Wireless Meeting Solution

BenQ's InstaShow™ is the wireless presentation solution that lets you share ideas immediately from nearly any device. Allowing up to 32 users to share simultaneously, InstaShow™ can boost meeting engagement and enhance collaboration. Furthermore, InstaShow™'s interactive response feature helps presenters focus on their audience by allowing them to control a laptop via a touchscreen. Most importantly, InstaShow™ incorporates strong security features to ensure corporate's innovative ideas are safeguarded. Whether you need to host a small impromptu brainstorming session or a large-scale corporate presentation, InstaShow™ makes sharing content simple, speedy, and secure.

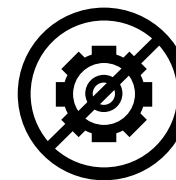

No Software Setup or Maintenance

InstaShow™ doesn't need any software installation or execution. There's no setup, configuration, or waiting for pop-ups to launch. Just plug into your PC or Mac and start presenting immediately.



True Plug & Play

Simply connect InstaShow™ into your device then push the button to start presenting immediately without hassle, without time waste. Up to 32 presenters can take part by using the InstaShow™ Button Kit.

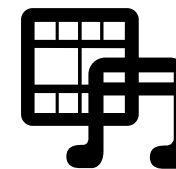

Smooth Video and Audio Quality

With HDMI 1.4a video output standard and 16 bit, 48Hz audio quality, InstaShow™ supports up to 60Hz full HD 1080p video and stereo sound without cable clutter or complicated driver selection.



Latest Wifi Technology

The latest 802.11ac WiFi guarantees extremely smooth wireless streaming without lag or buffering.



Strong Security

The security encryption and authentication protocols make this product safe, allowing to share confidential information without any concern for security breaches.

InstaShow™ WDC20

Future's Presentation

The landscape of the modern workplace is evolving beyond digital connectivity to mobility and ubiquity. Users expect devices to respond instantly, apps to control at their fingertips, and information to be available on demand. These changes will affect the way corporates have their meetings in the next years. The future presentation will be instant, with the possibility to share the content from any device in real time. This is why BenQ introduced InstaShow™.

InstaShow™ bypasses the complicated steps of IP addresses, driver installation, app execution, setting selection, etc., to quickly deliver professional, stable visual quality for teams to collaborate freely and confidently. Whether you need to host a small impromptu brainstorming session or a large-scale corporate presentation, the new InstaShow™ WDC20 makes sharing content simple, speedy, and secure. In addition, it is possible to stream wireless via portable devices, without any further installation.

Mobile Sharing



Interactive Response



Split Screen



The Meeting Room Simplified

Using your phone or tablet to share ideas with an audience has never been easier. InstaShow™ WDC20 supports mobile devices, such as Android and iOS smartphones and tablets, making it easier than ever to share. You can smoothly stream Full HD content wirelessly from your smart device to a large display immediately without limitations. With the InstaShare™ app, available for Android and iOS, you can further share and manage your files. Just connect to InstaShow™'s Wi-Fi receiver and you're ready to start presenting.

To further ease the flow of the meeting, InstaShow™ WDC20 also allows multiple presenter to share their screen simultaneously with the newly added split screen mode making the comparing of documents or putting further emphasize on essential elements a breeze.

InstaShow™ WDC10 / WDC10C

Now with Type C Connection



WDC10

All Hardware Solution

InstaShow™ provides integrated hardware encoding and decoding, providing peace of mind for assured wireless presentation performance regardless of the operating system capabilities of the source notebook.

Up to 16 Paired Buttons

InstaShow™ significantly enhances corporate efficiency and agility by offering a natural, intuitive way for up to 16 presenters to start presentations without waiting and wasting valuable meeting time.

Presenter-Controlled Video Mode Switching

Our exclusive InstaVideo function optimizes InstaShow™'s audiovisual settings to spontaneously switch from clear presentation mode to smooth video mode with stereo sound at the click of a side button. This is all done without IT support, cable clutter or complex software settings.

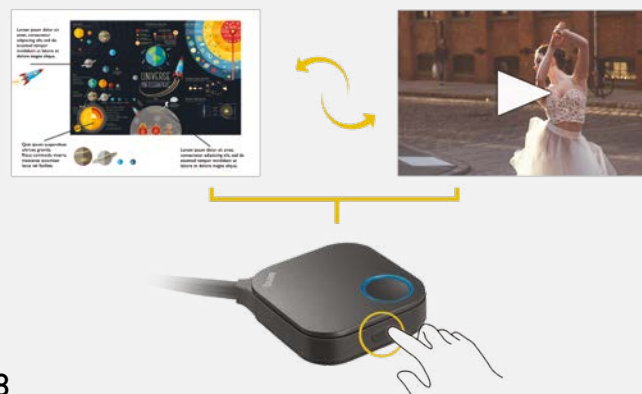

WDC10C

Single Cable Solution

Thanks to the type C USB cable, InstaShow™ WDC10C allows a fast a simple connection using only one cable.

Better Reliability for Cable Connection

The new cable is more resistant than ever before: it can now resist for years without any damage. Stress test show resistance up to 6000 swings.

Supports DMS

InstaShow™ supports DMS Local (Device Management Solution): a software tool for computers that enables remote and centralized management of multiple digital projectors by IT administrators/technicians via a local network. DMS Local's management capabilities include the ability to remotely monitor, control, and configure projectors individually or as groups.



InstaShow™ Complete Product Line

	WDC10	WDC10C	WDC20
High Security	✓	✓	✓
Interactive Response			✓
Split Screen Function			✓
Connection	HDMI	USB Type C	HDMI
WiFi Streaming	IEEE 802.11ac, 5GHz, 2T2R	IEEE 802.11ac, 5GHz, 2T2R	IEEE 802.11ac, 5GHz, 2T2R IEEE 802.11n, 2.4GHz, 2T2R
Maximum Presenters	16	16	32

What Makes InstaShow™ Series the Perfect Solution for the Most Demanding Applications

Robust Security

Software-Free Highly Secure Operation

Just plug InstaShow™ into a laptop and you are ready to share securely. Because it's an all-hardware solution that requires no software, drivers, or downloads of any kind, InstaShow™ completely eliminates many potential entry points that viruses and malware can exploit.

Trustworthy Security Protection

InstaShow™ keeps important corporate intellectual property private and safe from tampering or unintended disclosure, ensuring future business sustainability. AES 128-bit security encryption and the WPA2 authentication protocol guarantee that presentations are absolutely secure. The security handshake also assures smooth, high-quality wireless streaming of presentations. This allows presenters to share confidential information without worrying about security breaches. InstaShow™ also supports HDCP to ensure that content with digital rights management will play smoothly without delay, error messages, or interruption.



Reliably Stable Wireless Connection

Simple and convenient, InstaShow™ is also steadfastly reliable. Our exclusive automatic WiFi channel selection and auto-reconnect features allow presenters to depend on InstaShow™, without concern for any stoppages or interruptions caused by unstable WiFi environments. Equipped with WiFi 802.11ac for high performance up to 867Mbps, InstaShow provides smooth wireless streaming of Full HD 1080p content without lagging, even in wireless traffic-heavy environments. IT managers can rely on InstaShow™ to reduce user complaints and helpdesk resources.

The Highest Security Protocols, For Even the Most Demanding of Industries

Security is high on the agenda for any industry working with technology and few industries have higher demands, and more to lose, than **banks**, the **military** and the **police**. Risks ran in these industries are numerous, with these being the most compelling reasons to invest in high quality, secure products.

Your Reputation is on the Line

Data breaches are regarded as a serious risk because it leads to losing public trust. It could occur because of a company's weak cybersecurity strategy and it is difficult to recover from. It is important to take responsibility about cybersecurity and other measures that must be taken to protect their private information. To be a trusted company, it is important to have a strong cybersecurity plan to prevent this happening at all costs.

GDPR

In 2018, the General Data Protection Regulation came into effect and forces any company, even government agencies, to take full responsibility on protecting customer data. Failure to prevent or properly communicate data breaches can come with severe financial penalties. So not only would reputation take a massive blow, the direct financial impact is also something to be seriously considered.

Disruption in day-to-day Business

Fixing a data breach will cost a lot of time (and thus money) which will threaten a company's essential functioning. Investing in proper equipment that will prevent a data breach happening in the first place would be preferable.

How InstaShow™ keeps your Data Safe

- 1) Hardware-based solution with no device drivers.
- 2) An extra layer of data encryption.
- 3) Isolated Network System.



InstaShow™'s security is endorsed by the public and corporate end users in the defence, police, banking and government sectors. For more information, please [contact BenQ](#).

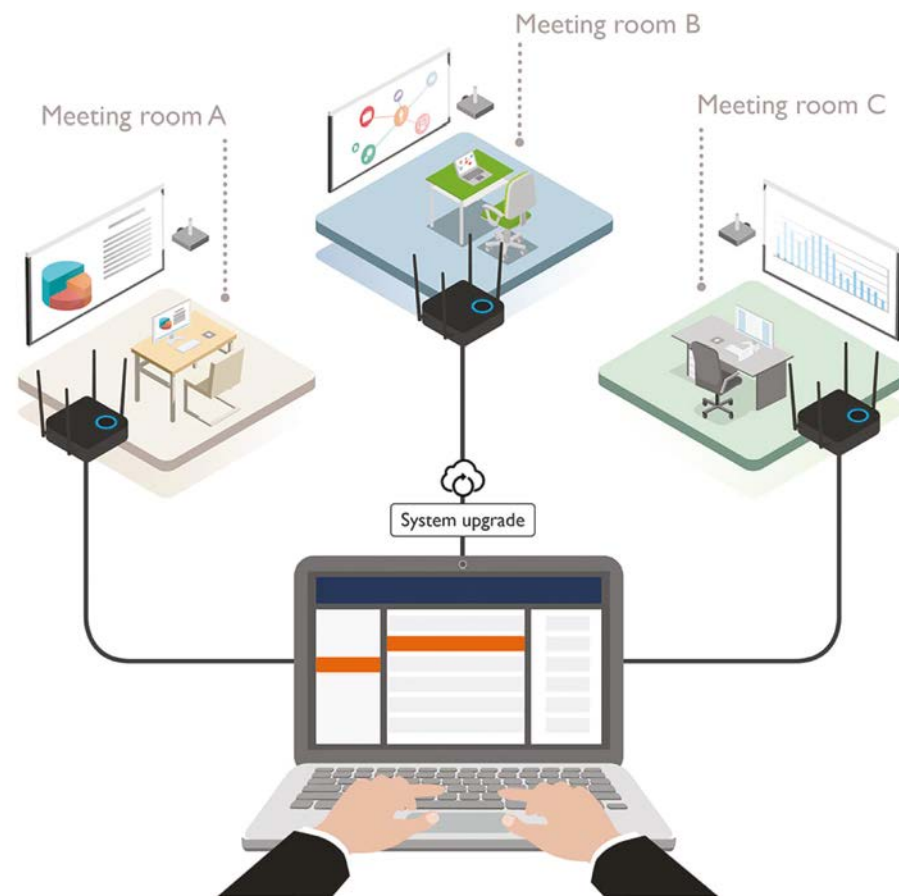

Efficient Centralized Control

Centralized control streamlines device management and makes updating easy. IT administrators can manage InstaShow™ remotely via LAN to control pairings, adjust settings, and update firmware conveniently with BenQ's OTA technology.

This builds further on the ease-of-use philosophy of InstaShow™. Gone are the days where the responsible IT admin needs to go to each meeting room separately to make changes that interrupt a meeting, they can now sit back with a nice cup of coffee and make changes in real-time. This can be done in the same building or even from the other side of the world, greatly saving time and travel costs and helping the IT department focus their efforts on different, more complicated tasks.

Fast Response for Presentation Video and Animation

Infinitesimal input latency lag less than 100ms enables natural, precise mouse movements and smooth execution of Powerpoint animations and transitions for professional-looking presentations. Corporate presenters and participants can concentrate on the meeting with the smoothest flow and follow critical points of the content intuitively.

Benefits of Web Management

- Firmware upgrade**
 Upgrading firmware can be tricky; with InstaShow™ it is possible to simply use a web browser and LAN connection to perform this task.
- SSID/Password Management**
 With the web password management application, IT managers can easily customize the SSID and password for each InstaShow™ to make it easier for the presenter to connect.
- Device Management**
 Via the web management application it is possible to monitor all the InstaShow™ buttons connected, as well as pair new ones or remove the existing connection.
- Video/Presentation Mode**
 Next to controlling the presentation mode with the mode switching button, you can also do the same via web application.
- Custom Screen Message**
 You can create a custom screen message on the loading screen to improve your company branding.
- On/Off Schedule**
 When needed you can set a specific time to restart all your InstaShow™ hosts.



Model	WDC10	WDC10C	WDC20
Feature			
Video Outputs	HDMI 1.4, comply with HDCP	HDMI 1.4, comply with HDCP	HDMI 1.4, comply with HDCP
Frame Rate	Up to 60 fps depending on environment	Up to 60 fps depending on environment	Up to 60 fps depending on environment (FHD)
Output Resolution	800x600, 1280x720 (720P), 1024x768 (XGA), 1280x768, 1280x800 (VXGA), 1280x1024, 1280x960, 1360x768, 1440x900, 1400x1050, 1680x1050, 1920x1080 (1080p)	800x600, 1280x720 (720P), 1024x768 (XGA), 1280x768, 1280x800 (VXGA), 1280x1024, 1280x960, 1360x768, 1440x900, 1400x1050, 1680x1050, 1920x1080 (1080p)	720x480, 720x576, 1280x720, 1920x1080 (1080p), up to 3840x2160 (30Hz)
Input Resolution	Up to 1920 x 1080	Up to 1920 x 1080	Up to 1920 x 1080
Simultaneous Connections	16 pcs	16 pcs	32 pcs
Audio	Stereo, Radio quality 16bits 48KHz	Stereo, Radio quality 16bits 48KHz	Stereo, Radio quality 16bits 48KHz
Wireless	IEEE 802.11ac, 5GHz, 2T2R	IEEE 802.11ac, 5GHz, 2T2R	IEEE 802.11ac, 5GHz, 2T2R IEEE 802.11n, 2.4GHz, 2T2R
Data Rate Wireless	Up to 867Mbps	Video Up to 867Mbps	Up to 867 + 300Mbps
Authentication Protocol	WPA2 (WPA2-PSK (Pre-Shared key) / WPA2-Enterprise)	WPA2 (WPA2-PSK (Pre-Shared key) / WPA2-Enterprise)	WPA2 (WPA2-PSK (Pre-Shared key) / WPA2-Enterprise)
Security (Encryption)	AES 128 bit	AES 128 bit	AES 128 bit
Support Platform	Windows, MAC, Chrome. Any OS supports HDMI standard 1.4	Windows, MAC, Chrome. Any OS has USB-C with Thunderbolt 3 or USB-C with Display Port Alt Mode (DP version higher or equal than 1.2)	Windows, MAC, Chrome. Any OS supports HDMI standard 1.4
Reach	Max. 8 meters	Max. 8 meters	Max. 15 meters
Temperature Range	Operating: 0°C to +40°C (+32°F to +104°F) Storage: -10°C to +60°C (+14°F to +140°F)	Operating: 0°C to +40°C (+32°F to +104°F) Storage: -10°C to +60°C (+14°F to +140°F)	Operating: 0°C to +40°C (+32°F to +104°F) Storage: -10°C to +60°C (+14°F to +140°F)
Humidity	Storage: 5% to 90% Operation: 10% to 80%	Storage: 5% to 90% Operation: 10% to 80%	Storage: 5% to 90% Operation: 10% to 80%
InstaShow Button			
Cable	USB Type A, HDMI Cable	USB Type-C	USB Type A, HDMI Cable
Reset Button	x 1	x 1	x 1
Mode Key	x 1	x 1	N / A
LED	*Red (boosting), Green (wifi connected), Blue (presenting)	*Red (boosting), Green (wifi connected), Blue (presenting)	3/6 LED (R.G.B)
Power Supply	DC 5V±10%, 0.9A	DC 5V±10%, 0.9A	DC 5V±10%, 0.5A
Power Consumption	Normal: 4.5W	Normal: 4.5W	Normal: 2.5W
Dimension (W x H x D)	84.5 x 189.55 x 19.9 mm	84.5 x 188.3 x 19.9 mm	81 x 291 x 24.2 mm
Weight	100g	87.3g	81g
InstaShow Host			
Power Button	x 1	x 1	x 1
Pairing Key	x 1	x 1	x 1
LAN	x 1 (10 / 100 Mbps)	x 1 (10/100 Mbps)	x 1
Video Output	x 1 HDMI 1.4 (video and audio)	x 1 HDMI 1.4 (video and audio)	x 1 HDMI 1.4 (video and audio)
LED	*Red (boosting), Green (ready for connection), Blue (presenting)	*Red (boosting), Green (ready for connection), Blue (presenting)	*Red (boosting), Green (ready for connection), Blue (presenting)
DC Power Jack	x 1 (micro USB)	x 1 (micro USB)	x 1 (micro USB)
Power Supply	DC 5V±10%, 1.5A	DC 5V±10%, 1.5A	DC 12V±10%, 2A
Power Consumption	Normal: 5W / Network standby: 2W / HDMI standby: 0.02W	Normal: 5W / Network standby: 2W / HDMI standby: 0.02W	Normal: 24 W
Dimension (W x H x D) (not include rubber feet)	110 x 110 x 27 mm (99 mm with antenna)	110 x 110 x 27 mm (99 mm with antenna)	200 x 150 x 140 mm (with Antenna)
Weight	150g	150g	330g
Cradle			
Dimension	85 x 97.5 x 170.4 mm	85 x 97.5 x 170.4 mm	100.4 x 92.6 x 152 mm
Weight	630g	630g	550g
Package			
InstaShow Button	x 2	x 2	x 2
InstaShow Host	x 1	x 1	x 1
Cradle	x 1	x 1	x 1
Power Cable	x 1 (15 cm, USB Type A 3.0, micro USB)	x 1 (150 cm, USB Type A 3.0, micro USB)	x 1 (150 cm, USB Type A 3.0, micro USB)
HDMI Extra Cable	x 1 (80 cm)	x 1 (80 cm)	x 1
USB Extended Cable	x 1 (15 cm), x 1 (80 cm)	x 1	x 1 (80cm)
Antenna	x 2 (Black)	x 2 (Black)	x 4 (Black)
Adapter	x 1	x 1	x 1
Quick Start Guide	x 1	x 1	x 1
Safety Statement	x 1	x 1	x 1
Double-side Sponge Tap	x 1	x 1	No

* Please find detail LED behavior in the user manual. **Wireless connection speed is depended on wireless environment.

